

WARMAN®
Centrifugal Slurry Pumps

Excellent
Minerals
Solutions

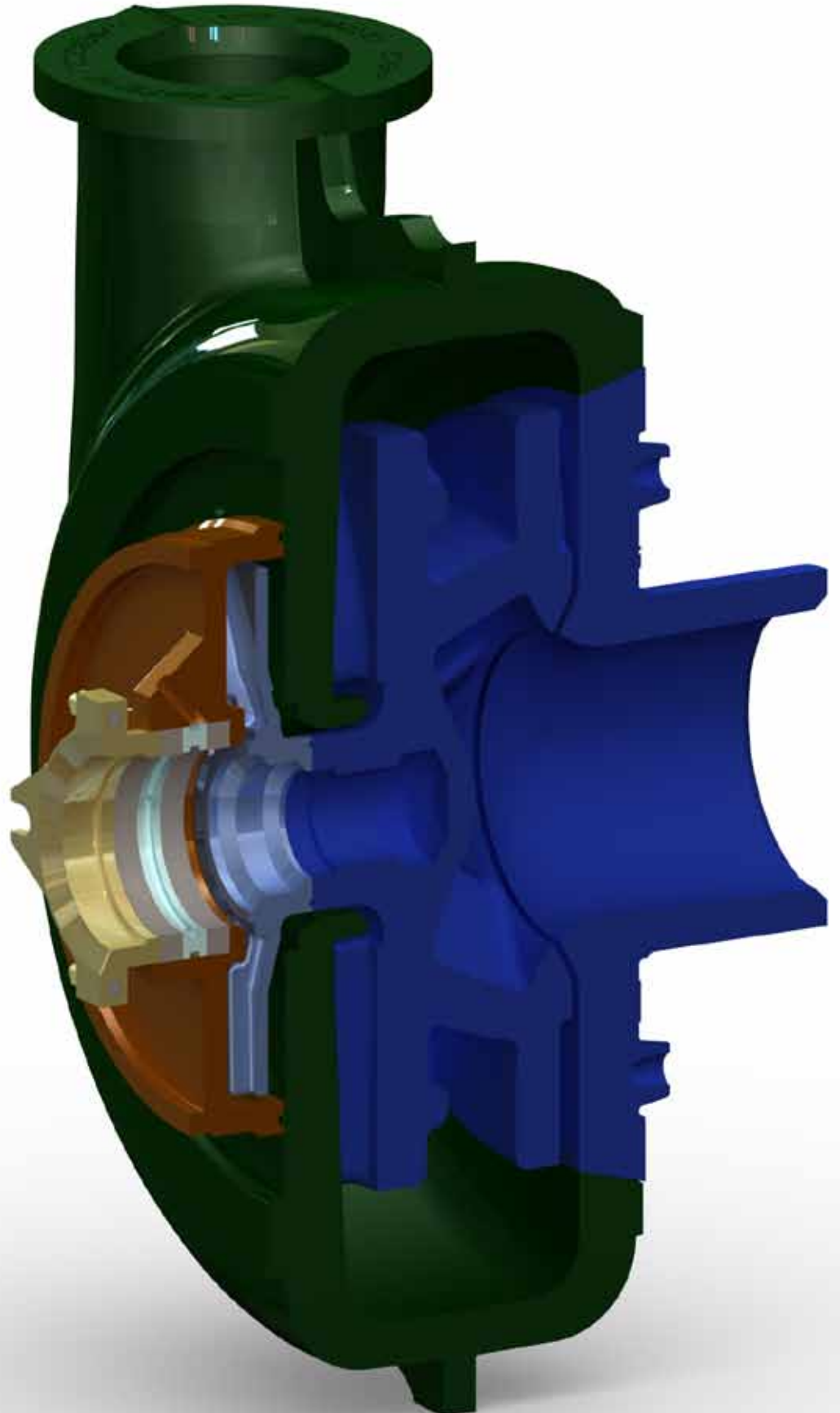

AH™ upgrade



Weir Minerals are specialists in delivering and supporting slurry and dewatering equipment solutions including pumps, hydrocyclones, valves and wear resistant linings for global mining and mineral processing, the power sector and general industry.

Warman® WRT™ improvements

Years of actual wear data on the popular Warman® 8/6 AH™ pump enabled our design engineers to use a novel integrated design approach, comparing this “real world” data with our computational fluid dynamics (CFD) simulation to obtain correlation between predicted and actual results for the standard 5 vane slurry impellers.

This has resulted in the introduction of the new WRT™ impeller and throatbush design. The new impeller design incorporates a unique vanelet on the back shroud which streamlines the flow through the impeller. This new combination provides significantly improved wear life, with rigorous field testing showing increases in wear life of up to 50% on the previous design. This improvement also gives higher efficiency and therefore lower absorbed power and improvements in the NPSH performance. This development will ultimately cover the complete AH™ range in metal or rubber fit up.

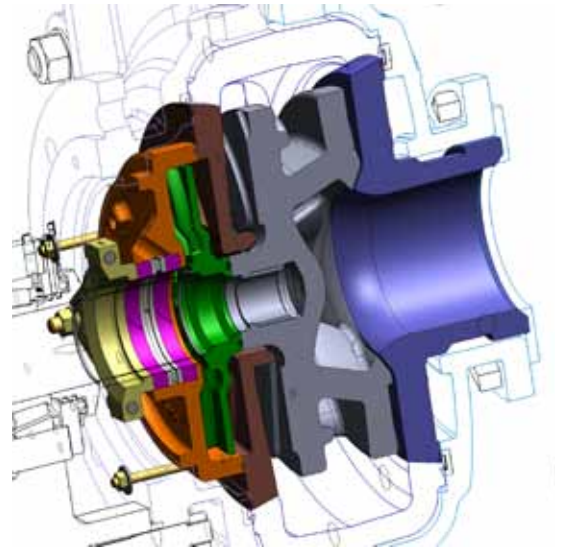

Hi Seal® expellers

A significant improvement in performance over the original expeller sealing method is achieved by the Hi Seal® design. The patented expelling vane shape and larger diameter expeller generates a significantly increased pressure in the expeller ring chamber at the same pump speed as compared to the previous sealing arrangement. Benefits of the modification include

- Improved sealing performance
- Elimination of seal leakage
- Extended component wear life
- Reduced power consumption
- Reduced operation cost
- Reduced maintenance related costs.

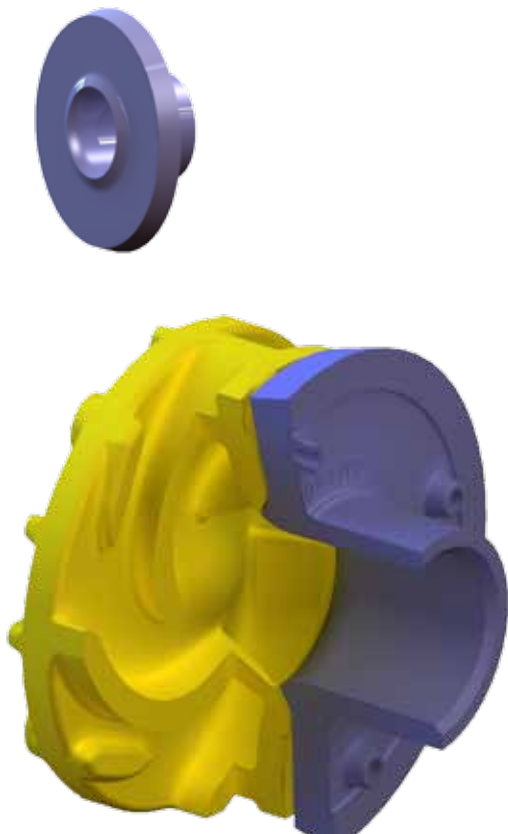

Weir Minerals products have a deserved reputation for extended wear life and reliability, bringing the customer the lowest cost of ownership.

Profiled rubber liners

In addition to the above impeller developments, we have introduced a new profile to the rubber liners. The new liners have been thoroughly tested in the toughest slurry applications and have proven to outlast traditional designs achieved through redistributing and thickening liner material within the wear areas of the pump casing. The new liners, identified by TL1, are now available on pump sizes from 3/2 to 8/6, and will be extended through to the 16/14 size pumps.

Materials technology - R55

To further assist one aspect of pump's wear performance, the R55™ material has been introduced. R55™ is a premium grade material for use in a high wear application. It is a black natural rubber, of low hardness and is used for pump liners and impellers, as well as cyclones. Superior physical properties give increased cut resistance to hard, sharp particle slurries, resulting in improved wear characteristics. It is particularly suitable for large particle erosive slurry applications such as mill discharge applications. Tests have consistently shown that wear life with R55™ can be increased by as much as 50% over previous materials.

The R55™ material has replaced our previous natural rubber grades such as R08A, R24, R26A, W411 and W413, brought about by progressive improvements in materials technology.

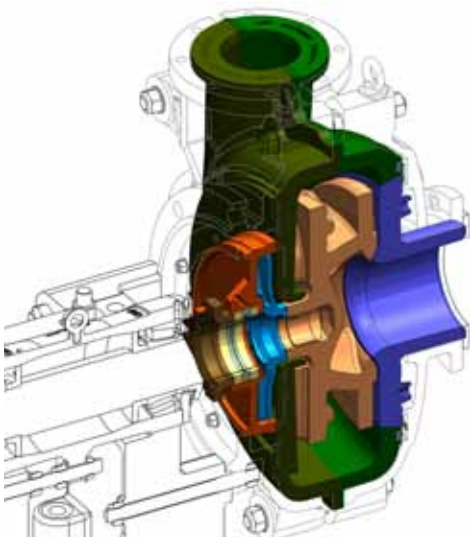
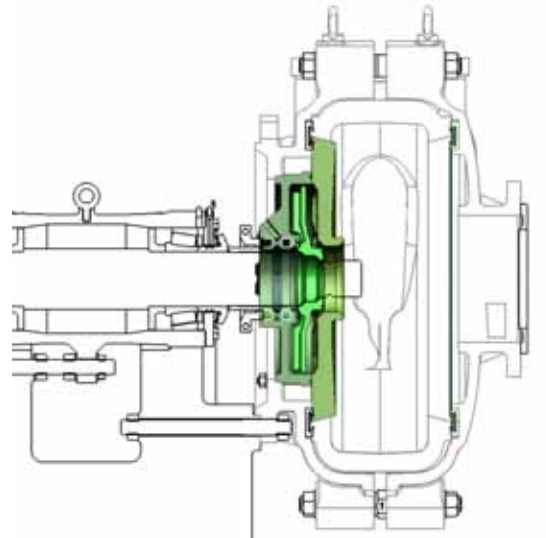

WARMAN® Centrifugal Slurry Pumps
ENVIROTECH® Centrifugal Slurry Pumps
GEHO® PD Slurry Pumps
LINATEX® Rubber Products
VULCO® Wear Resistant Linings
CAVEX® Hydrocyclones
FLOWAY® PUMPS Vertical Turbine Pumps
ISOGATE® Slurry Valves
MULTIFLO® Mine Dewatering Solutions
LEWIS® PUMPS Vertical Chemical Pumps
WEIR MINERALS RENTALS™



For further information on any of these products or support services, contact your nearest sales office or visit:

www.weirminerals.com

Weir Minerals Africa (Pty) Ltd.

PO Box 70, Isando, 1600 Tel.: +27 (0)11 929 2600
31 Isando Road, Isando, 1601 Fax.: +27 (0)11 929 2960
Gauteng sales-za@weirminerals.com
South Africa www.weirminerals.com

Excellent
Minerals
Solutions



WARMAN is a registered trademark of Weir Minerals Australia Ltd and Weir Group African IP Ltd; CAVEX and MULTIFLO are registered trademarks of Weir Minerals Australia Ltd; LEWIS PUMPS is a registered trademark of Envirotech PumpSystems Inc; GEHO is a registered trademark of Weir Minerals Netherlands bv; FLOWAY is a registered trademark of Weir Floway Inc.; VULCO is a registered trademark of Vulco SA; ISOGATE is a registered trademark of Weir do Brasil Ltda. AH and WRT are pending trademarks of Weir Minerals Australia Ltd. LINATEX is a registered trademark of Linatex Ltd, ENVIROTECH is a registered trademark of Weir Minerals Africa (Pty) Ltd

WMA/AH Upgrade (English ZA) 10/10

Copyright © 2010 Weir Minerals Africa (Pty) Ltd. Printed in South Africa